

IR SERIES MEDIUM DUTY RANGE  
WITH CONVECTION OVEN BASE

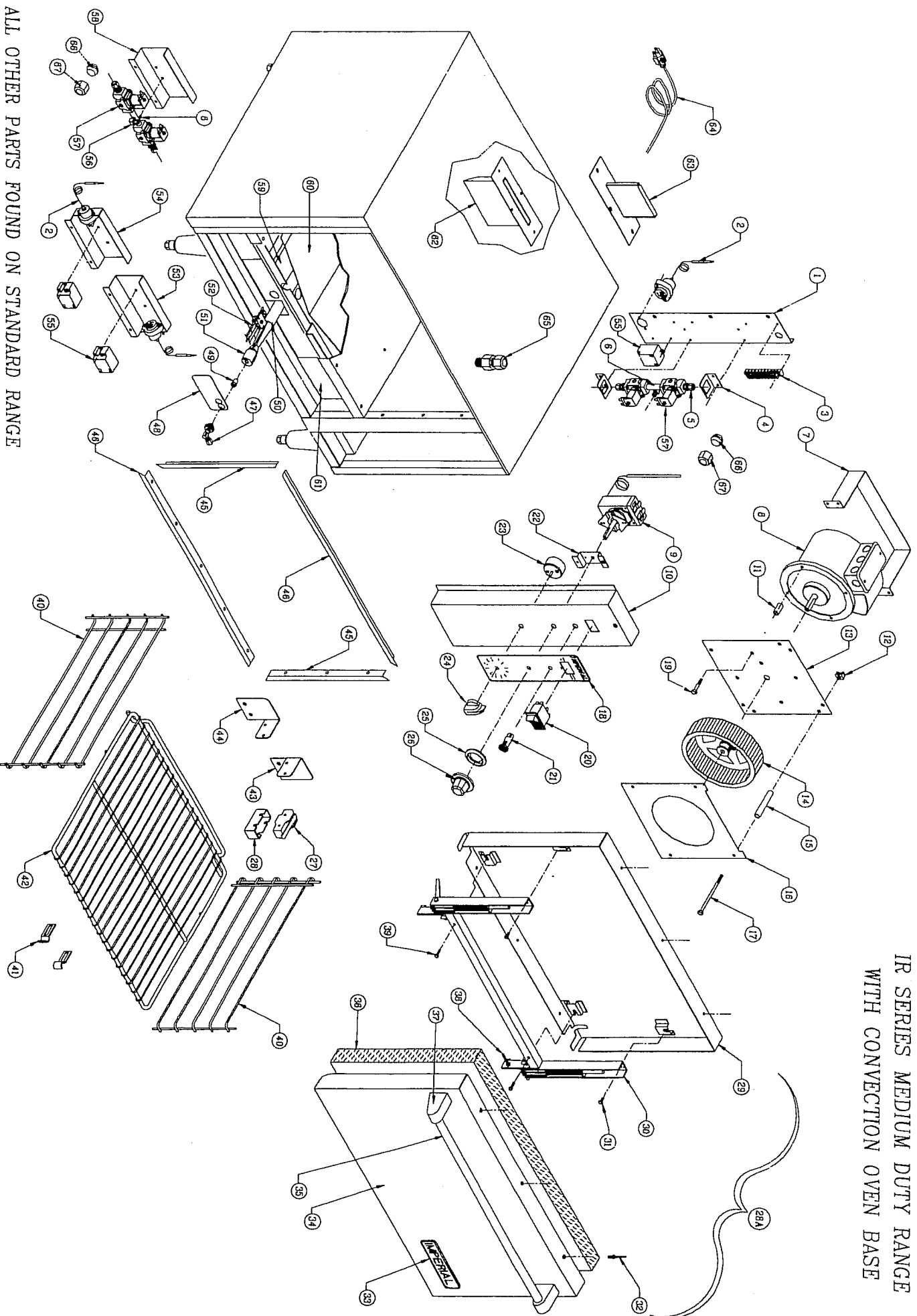

ALL OTHER PARTS FOUND ON STANDARD RANGE

## IR SERIES Medium Duty Ranges with Convection Oven Base

ITEM NO	DESCRIPTION	PART #	36"	48"	60"	72"
1	Control Bracket	20270	1	1	2	2
2	Flame Switch	N/A	1	1	2	2
***	Ignition Kit replaces the Flame Switch	37110	1	1	2	2
3	Terminal Block	1136	1			2
4	Solenoid Bracket	20271	2	2	4	4
5	Straight Fitting	2995	2	2	4	4
6	Manifold Pipe On 36" And 72" Units	20280	1			1
	Manifold Pipe On 48" And 60" Units	20281		1	1	
7	Motor Guard, Old Style	20272	1	1	2	2
	Motor Guard, New Style	35341	1	1	2	2
8	Motor 115V	1165-115	1	1	2	2
	Motor 220V	1165-220	1	1	2	2
9	Thermostat	1160	1	1	2	2
10	Control Panel - (R/H) Side	20290	1	1	2	2
	Control Panel - (L/H) Side	20291	1	1	2	2
11	Spacer 1/2"	30396	4	4	8	8
12	Self Retaining Nut	30378	4	4	8	8
13	Motor Mounting Plate Assembly	20273	1	1	2	2
14	Squirrel Cage	1166	1	1	2	2
15	Spacer 3"	30397	4	4	8	8
16	Squirrel Cage Cover	20274	1	1	2	2
17	Bolt 5"	30342	4	4	8	8
18	Control Decal	34623	1	1	2	2
19	Bolt 1-3/4"	30318	4	4	8	8
20	Power Switch	1126	1	1	2	2
21	Indicator Light	1124	1	1	2	2
22	Thermostat Bracket	20275	1	1	2	2
23	Manual Timer	1170	1	1	2	2
***	Electric Timer 115V 60HZ M450	32209	1	1	2	2
24	Timer Knob	1171	1	1	2	2
25	Bezel	1162	1	1	2	2
26	Thermostat Knob	1161	1	1	2	2
27	Door Switch	1155	1	1	2	2
28	Door Switch Cover	1156	1	1	2	2
28A	Door Assembly	20285	1	1	2	2
	<b>ASSEMBLY CONSISTS OF NEXT 11 ITEMS</b>					
29	Door Liner - Porcelainized	8003-1	1	1	2	2
30	Door Closing Mechanism	20162	1	1	2	2
31	Bolt 1/2"	30302	4	4	8	8
32	Door Rivets - S/S (bag of 10)	1070-SK	6	6	12	12
33	Imperial Logo	35840	1	1	2	2
	Name Plate Speed Nut	36569	2	2	2	2
34	Door Cover - S/S	20151	1	1	2	2
	Door Cover - Black Finish	20151B	1	1	2	2
***	Kick Plate	20143	1			2
***	Kick Plate					
35	Oven Door Handle - S/S	20153	1	1	2	2
36	Door Insulation	8040-1	1	1	2	2
37	Door Handle Bracket (Right Side)	36101	1	1	2	2
	Door Handle Bracket (Left Side)	36102	1	1	2	2

## IR SERIES Medium Duty Ranges with Convection Oven Base

ITEM NO	DESCRIPTION	PART #	36"	48"	60"	72"
38	Door Switch Activating Bolt	30371	1	1	2	2
	Whiz Lock Nut	30378	1	1	2	2
39	Bolt 1-1/2"	30320	4	4	8	8
40	Rack Guide - Chrome Plated	2023	2	2	4	4
41	Rack Guide Clips	30879	4	4	8	8
42	Oven Rack - Chrome Plated	4042-2	3	3	6	6
43	Door Switch Bracket (R/H) Side	20287	1	2	4	4
44	Door Switch Bracket (L/H) Side	20288	1	2	4	4
45	Side Door Gasket	20071	2	2	4	4
46	Top & Bottom Door Gasket	20070	2	2	4	4
47	90 Orifice Elbow W / Orifice	1604	1	1	2	2
48	Orifice mounting Bracket	20289	1	1	2	2
49	Oven Orifice - NAT.	2062	1	1	2	2
	Oven Orifice - L.P.	1700-52	1	1	2	2
50	Oven Burner W/ Air Shutter	1035	1	1	2	2
51	Air Shutter Only - For Oven Burner	1036	1	1	2	2
52	Oven Pilot W / Ignition Wire Attach - NAT.	1120	1	1	2	2
	Oven Pilot W / Ignition Wire Attach - L.P.	1120 & 1018	1	1	2	2
	Ferrel (Over Size) 3/16"	30319	1	1	1	2
***	#18 Pilot Bell Orifice Only NAT.	1017	1	1	2	2
***	#10 Pilot Bell Orifice Only L.P.	1018	1	1	2	2
	Compression Nut (Over Size) 3/16"	30267	1	1	1	2
53	Spark Module Bracket - (R/H) Side	20293	1	1	2	2
54	Spark Module Bracket - (L/H) Side	20294	1	1	2	2
55	Spark Module	1140	1	1	2	2
56	90 Elbow	30278	1	1	2	2
57	Solenoid Valve	1134	2	2	4	4
58	Solenoid Mounting Bracket	20295	1	1	2	2
59	Aeration Plate / Burner Support	20276	1	1	2	2
60	Flame Spreader	20277	1	1	2	2
61	Baffle Side Cover	20296	1	1	2	2
62	Snorkel Tube	20278	1	1	2	2
63	Flue Assembly	20279	1	1	2	2
64	Electrical Cord	1142	1	1	1	1
65	CC Straight Fitting 1/8" NPT X 3/8"	30870	1	4	2	2
66	Ferrel (Over Size) 3/16"	30319	1	1	2	2
	Ferrel 3/8"	30272	2	2	4	4
67	Compression Nut 3/16"	30277	1	1	2	2
	Compression Nut 3/8"	30266	2	2	4	4

### IR and IHR New Ignition System Parts

ITEM NO	DESCRIPTION	PART #	
**	Ignition Module- DSI 115v Fenwal	35682	1
**	Igniter- Spark and Sense electrode	33883	1
**	Ignition cable (part # comes with 4 cables)	35771	1
**	Gas Solenoid valve	1134	1